

F-2 Illustrator

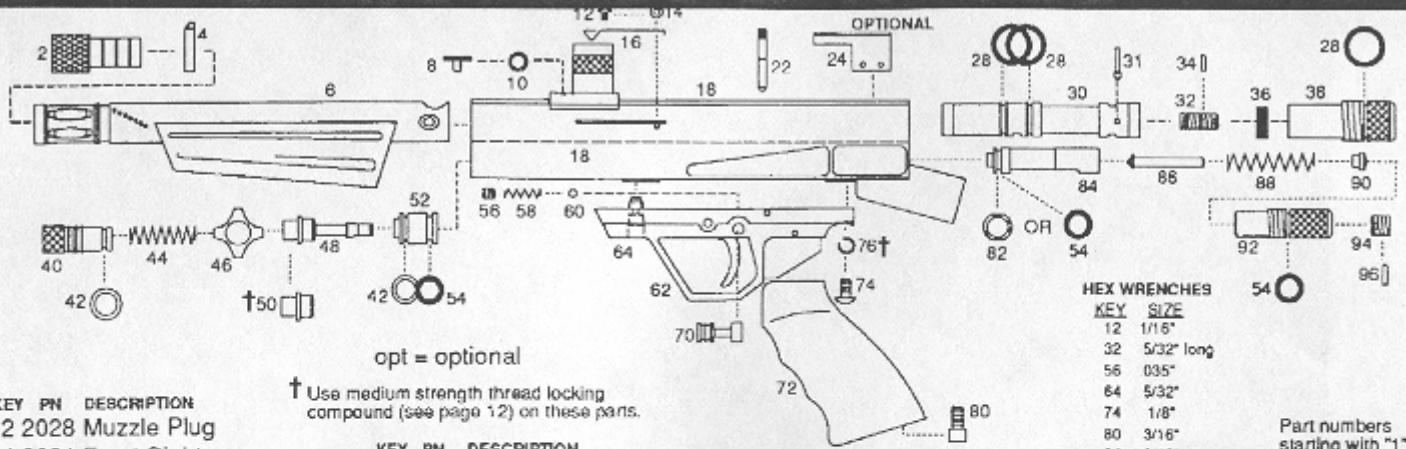

opt = optional

† Use medium strength thread locking compound (see page 12) on these parts.

HEX WRENCHES

KEY	SIZE
12	1/16"
32	5/32" long
56	035"
64	5/32"
74	1/8"
80	3/16"
94	3/16"

Part numbers starting with "1" are common with the F1.

KEY PN DESCRIPTION

- 2 2028 Muzzle Plug
- 4 2081 Front Sight
- 6 2019 Barrel
- 8 2058 Barrel Screw
- 10 2036 O-ring, 2-003, 70D
(very small, soft, black nitrile)
- 12 1054 Ball Spring Screw
(4-40 x 1/8" button head)
- 14 1064 Ball Spring Washer
(#4 external star)
- 16 2042 Ball Retention Spring
(black)
- 18 NA Receiver
- 22 2012 Cocking Assembly/Pin
- 24 2083 Sight Rail Extender (opt)
- 28 1032 O-ring, 2-016, 70D
(large, soft, black nitrile)

KEY PN DESCRIPTION

- 30 2014 Bolt
- 31 2073 Bolt Pin
(.093" x .73" NYLON)
- 32 2071 Bolt Screw
(5/16-24 x 3/4")
- 34 2072 Bolt Screw Pin
(.093" x .31" NYLON)
- 36 1069 Bolt Buffer
- 38 1008 Bolt Plug
- 40 1007 Reservoir Plug
- 42 1033 O-ring, 2-013, 90D
(small, hard, white urethane)
- 44 1041 Valve Spring
- 46 1067 Cup Seal Guide
(guide must be loose on seal; see p 12)
- 48 2017 Valve Pin (1 groove)
- 50 2030 Cup Seal†

KEY PN DESCRIPTION

- 52 2016 Valve Body
- 54 1034 O-ring, 2-013, 70D
(small, soft, black nitrile)
- 56 2059 Safety Spring Screw
(2-56 x 1/16")
- 58 1045 Safety Detent Spring
- 60 1024 Safety Detent (.067" ball)
- 62 2025 Trigger Assembly
- 64 NA Front Trigger/Valve
Body Screw (part of # 62)
- 70 1023 Trigger Safety
- 72 2026 Rear Grip
- 74 1051 Rear Trigger Screw†
(10-24 x 3/8" BH)
- 76 1062 Trigger Washer
(#10 split lock)

KEY PN DESCRIPTION

- 80 1050 Rear Grip Screw
(1/4-20 x 3/4" skt head)
- 82 1034T O-ring, 2-013, 75D
(small, soft, brown Viton)
- (OR) 1034U O-ring, 2-013, 70D
(small, soft, white urethane with black marks)
- 84 2011 Striker
- 86 2010 Striker Spring Guide
- 88 1040 Striker Spring
- 90 2068 Striker Spring Bearing
- 92 2009 Striker Plug
- 94 2074 Striker Plug Screw
(3/8-24 x 3/8")
- 96 2075 Striker Screw Pin
(.093" x .36" NYLON)