

F-2 Illustrator

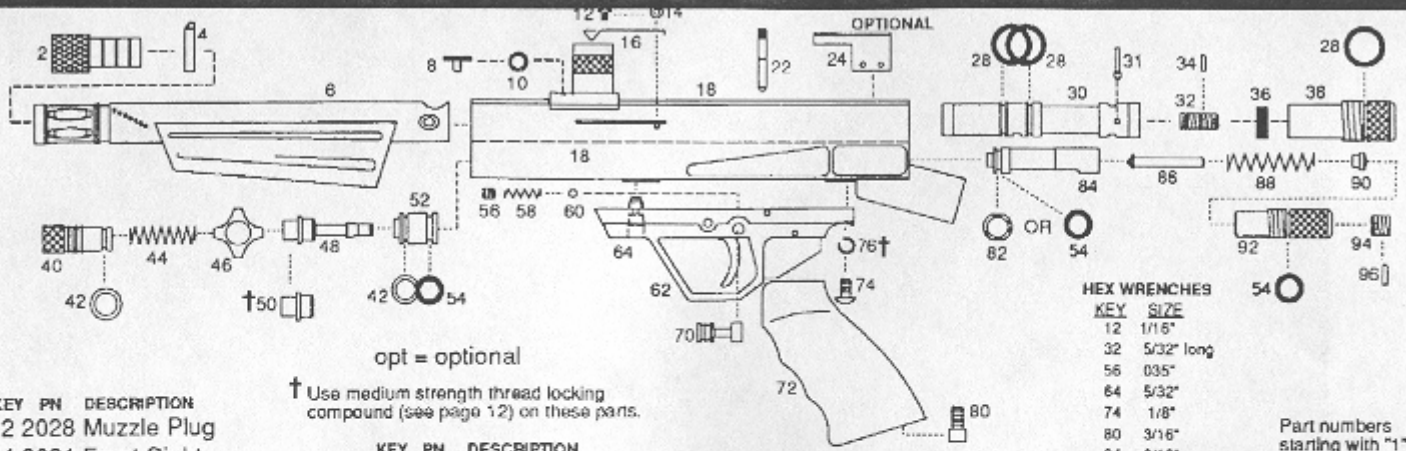

13

KEY PN	DESCRIPTION
2	2028 Muzzle Plug
4	2081 Front Sight
6	2019 Barrel
8	2058 Barrel Screw
10	2036 O-ring, 2-003, 70D (very small, soft, black nitrile)
12	1054 Ball Spring Screw (4 40 x 1/8" button head)
14	1064 Ball Spring Washer (#4 external star)
16	2042 Ball Retention Spring (black)
18	NA Receiver
22	2012 Cocking Assembly/Pin
24	2083 Sight Rail Extender (opt)
28	1032 O-ring, 2-016, 70D (large, soft, black nitrile)

opt = optional

† Use medium strength thread locking compound (see page 12) on these parts.

KEY PN	DESCRIPTION
30	2014 Bolt
31	2073 Bolt Pin (.093" x .73" NYLON)
32	2071 Bolt Screw (5/16-24 x 3/4")
34	2072 Bolt Screw Pin (.093" x .31" NYLON)
36	1069 Bolt Buffer
38	1008 Bolt Plug
40	1007 Reservoir Plug
42	1033 O-ring, 2-013, 90D (small, hard, white urethane)
44	1041 Valve Spring
46	1067 Cup Seal Guide (guide must be loose on seal; see p 12)
48	2017 Valve Pin (1 groove)
50	2030 Cup Seal†

KEY PN	DESCRIPTION
52	2016 Valve Body
54	1034 O-ring, 2-013, 70D (small, soft, black nitrile)
56	2059 Safety Spring Screw (2-56 x 1/16")
58	1045 Safety Detent Spring
60	1024 Safety Detent (.067" ball)
62	2025 Trigger Assembly
64	NA Front Trigger/Valve Body Screw (part of # 62)
70	1023 Trigger Safety
72	2026 Rear Grip
74	1051 Rear Trigger Screw† (10-24 x 3/8" BH)
76	1062 Trigger Washer (#10 split lock)

KEY	SIZE
12	1/16"
32	5/32" long
56	035"
64	5/32"
74	1/8"
80	3/16"
94	3/16"

Part numbers starting with "1" are common with the F1.

KEY PN	DESCRIPTION
80	1050 Rear Grip Screw (1/4-20 x 3/4" skt head)
82	1034T O-ring, 2-013, 75D (small, soft, brown Viton)
	(OR) 1034U O-ring, 2-013, 70D (small, soft, white urethane with black marks)
84	2011 Striker
86	2010 Striker Spring Guide
88	1040 Striker Spring
90	2068 Striker Spring Bearing
92	2009 Striker Plug
94	2074 Striker Plug Screw (3/8-24 x 3/8")
96	2075 Striker Screw Pin (.093" x .36" NYLON)